

Land Registry

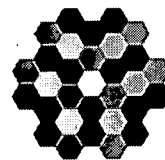

25 November 2024

Your ref
LSG5/WC1

Our ref
LA688305 /OC/166

HM Land Registry
Durham Office
PO Box 75
Gloucester
GL14 9BD

DX 321601 Gloucester 33
Tel 0300 006 0010
Fax NA
Email durham.office@landregistry.gov.uk
www.gov.uk/land-registry

Official copy/copies

HM Land Registry payment ref 25/11 Z0FY9PHW
Fee debited £3.00

The official copy/copies of the title plan or certificate in form CI you applied for is/are enclosed.

You did not apply for an official copy of the register.

Please contact the HM Land Registry Office named if you have any questions about the enclosed official copy/copies.

LSG5/WC1

LANCASHIRE COUNTY COUNCIL
LEGAL SERVICES - WENDY CLARKE
LANCASHIRE COUNTY COUNCIL
PO BOX 100
PRESTON
PR1 0LD

DO NOT

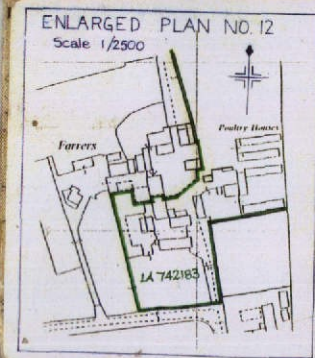
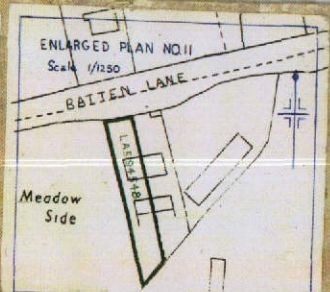
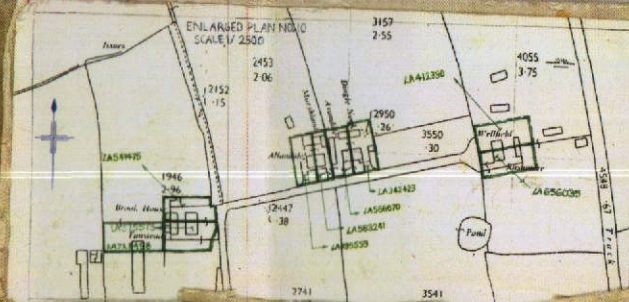
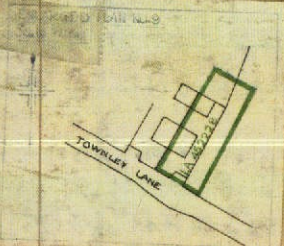
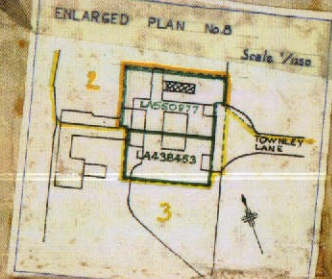
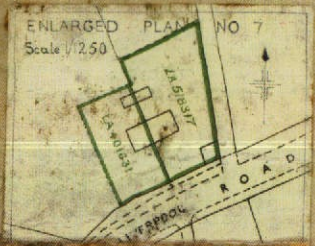

This official copy shows the current state of the title plan. It is admissible in evidence to the same extent as the original (s.67 Land Registration Act 2002). This title plan shows the general position, not the exact line, of the boundaries. It may be subject to distortions in scale. Measurements scaled from this plan may not match measurements between the same points on the ground. © Crown Copyright. Produced by HM Land Registry. Reproduction in whole or in part is prohibited without the prior written permission of Ordnance Survey. Licence Number 100026316.

PLANNING PERMISSION	DATE	REFERENCE
P 1935	7.10.72	LA334775
P 23225	16.2.73	LA372425
P 38073	20.7.73	LA364450
P 38074	2.8.73	LA360882
P 38075	10.9.73	LA364580
LA 15439	16.11.73	LA371824
LA 156184	27.6.1974	LA385805
LA 195559	14.10.74	LA367322
LA 152277	21.10.1975	LA401631
LA 227110	14.11.1977	LA419390
LA 227110	12.9.1979	LA438453
LA 227110	18.2.1980	LA444155
LA 227110	21.10.1980	LA458206
LA 227110	1.5.1981	LA458187
LA 227110	9.10.1981	LA463868

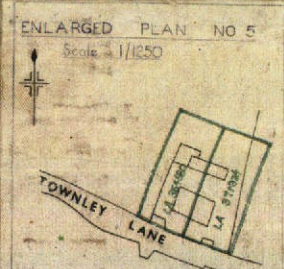
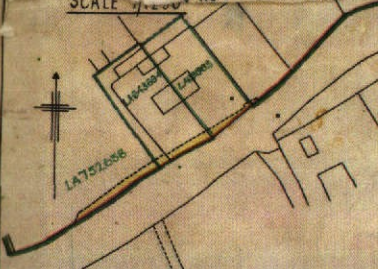
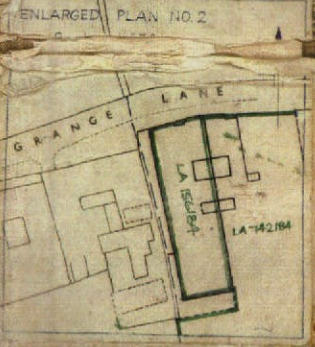
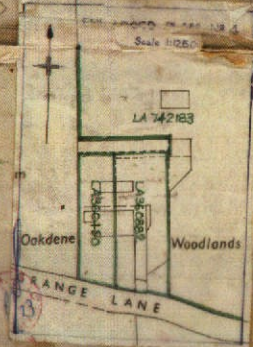

LA688305