

These are the notes referred to on the following official copy

Title Number LA688305

The electronic official copy of the document follows this message.

This copy may not be the same size as the original.

Please note that this is the only official copy we will issue. We will not issue a paper official copy.

LYTH DLR

Form 19 (r.72) 27 MAR 1992

Land Land Registration Acts 1929 to 1971

H.M. Land Registry
RECEIVED 00

TRANSFER OF PART



County and district Lancashire - South Ribble



Title Number To be allocated - part of LA.688305

Property 136 Liverpool Road Hutton Preston Lancashire

Date 6th March 1992

In consideration of Seventy seven thousand pounds (£77,000.00) the receipt whereof is hereby acknowledged

We The Lancashire County Council of County Hall Preston Lancashire PR1 8XJ (hereinafter called "the Transferor") as beneficial owners hereby transfers to William Sutton and Jane Elizabeth Sutton both of 9 Lindle Close Hutton Preston Lancashire (hereinafter called "the Transferees") ALL THAT property known as 136 Liverpool Road Hutton Preston Lancashire more particularly shown on the plan annexed hereto and thereon edged red together with a right of way with or without vehicles and for all reasonable purposes in connection with the use of the property over and along the land hatched blue on the said plan The Transferees hereby jointly and severally covenant with the Transferors:

- (a) To at all times hereafter maintain at their own expense and keep in a proper state of repair and condition sufficient

to turn stock fences hedges and walls on the boundaries of the property hereby transferred as are marked with a letter "T" inwards on the said plan

- (b) At the Transferees own expense to hereinafter maintain in a proper state of repair and condition the access area shown hatched blue on the said plan
- (c) Not to cause or allow to be or to be done on the property hereby transferred anything which shall or may be deemed to become a nuisance obstruction annoyance or inconvenience to the property retained by the Transferor or any part thereof or to the occupiers thereof
- (d) To use the property hereby transferred only as a single private dwellinghouse and for no other purpose and not to construct or erect any buildings or erections on the property hereby transferred other than those which might reasonably be associated with such use as aforesaid

The Transferees hereby declare that the survivor of them can give a valid receipt for capital money arising on the disposition of the land

IT IS HEREBY CERTIFIED that the transaction hereby effected does not form part of a larger transaction or of a series of transactions in respect of which the amount or value or the aggregate amount or value of the consideration exceeds the sum of Two hundred and fifty thousand pounds

THE COMMON SEAL of The Lancashire County)
Council was hereto affixed in pursuance)
of a resolution authorising the sealing)
hereof:)

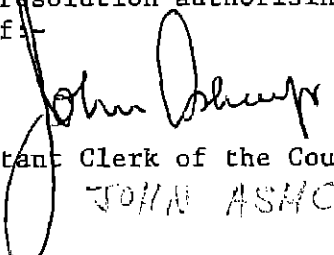
Assistant Clerk of the Council

JOHN ASHCROFT

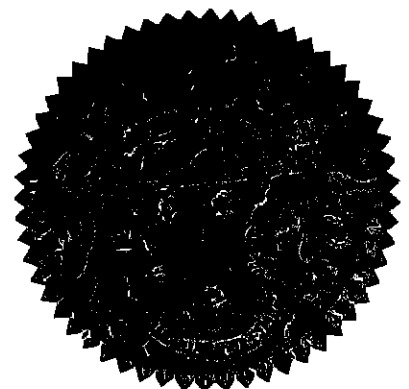

8053

Signed as his Deed by the said William Sutton)
in the presence of:-)

W. Sutton

Name..... *Henry Sutton, LL.B.*
Address..... *Sutton*
.....
Occupation..... *17 Liverpool Rd, London*
Preston, PPA 2AD

Signed as her Deed by the said Jane)
Elizabeth Sutton in the presence of:-)

J.E. Sutton

Name..... *J. Sutton*
Address..... *17 Liverpool Rd, London*
.....
Occupation..... *17 Liverpool Rd, London*
Preston, PPA 2AD
TEL: 072 31200 FAX: 072 31200

Scale 1/500

L
i
v
e
r
p
o
o
l
R
o
a
d

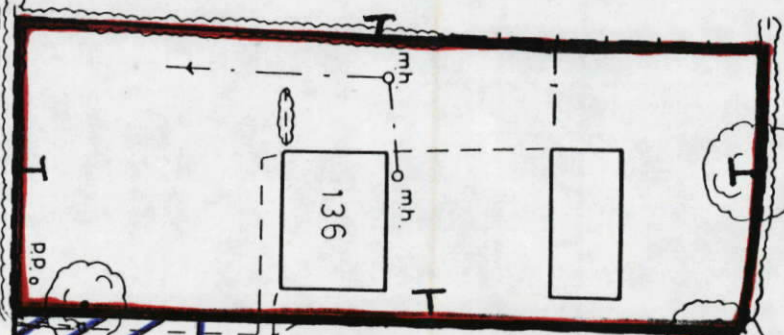

Hutton
W. [unclear]

H137
H M LAND REGISTRY
 Title No: LA 694204
 COPY (liable to distortion in scale)
 of plan to TRANSFER
 dated 6 MARCH 1997

6/80



John [unclear]
 Assistant Clerk of the County Council

