

**From:** [Elliott, Jayne](#)  
**To:** [jcolinwright@hotmail.co.uk](mailto:jcolinwright@hotmail.co.uk)  
**Cc:** [Mort, Jennifer](#)  
**Subject:** Conder Green to Nans Buck claimed public footpath  
**Date:** 13 March 2013 13:56:00  
**Attachments:** [Order plan showing proposed modification in red.pdf](#)

---

Hello Colin,

Thankyou for meeting me on 6th March at Conder Green picnic site to discuss the correct alignment of the Order route.

I have attached a copy of the Order plan showing the route that I understand to be the one claimed by the parish council passing Pennyhill and Waterloo marked by a thick red line.

Could you please confirm that the line marked red correctly shows the exact route used by the users that have completed evidence of use forms submitted as part of your application. Only when we are confident that the full length of the route shown on the Order plan (as amended) is the one that has been used by members of the public can we make a decision whether we can ask for the Order to be modified or determine whether we need to start again with a new Order.

Jayne

Jayne Elliott  
Public Rights of Way Definitive Map Officer  
Lancashire County Council  
Environment Directorate

Mobile: 07917 836626  
Email: [jayne.elliott@lancashire.gov.uk](mailto:jayne.elliott@lancashire.gov.uk)

Please note that my normal working days are Tuesday, Wednesday and Thursday each week.

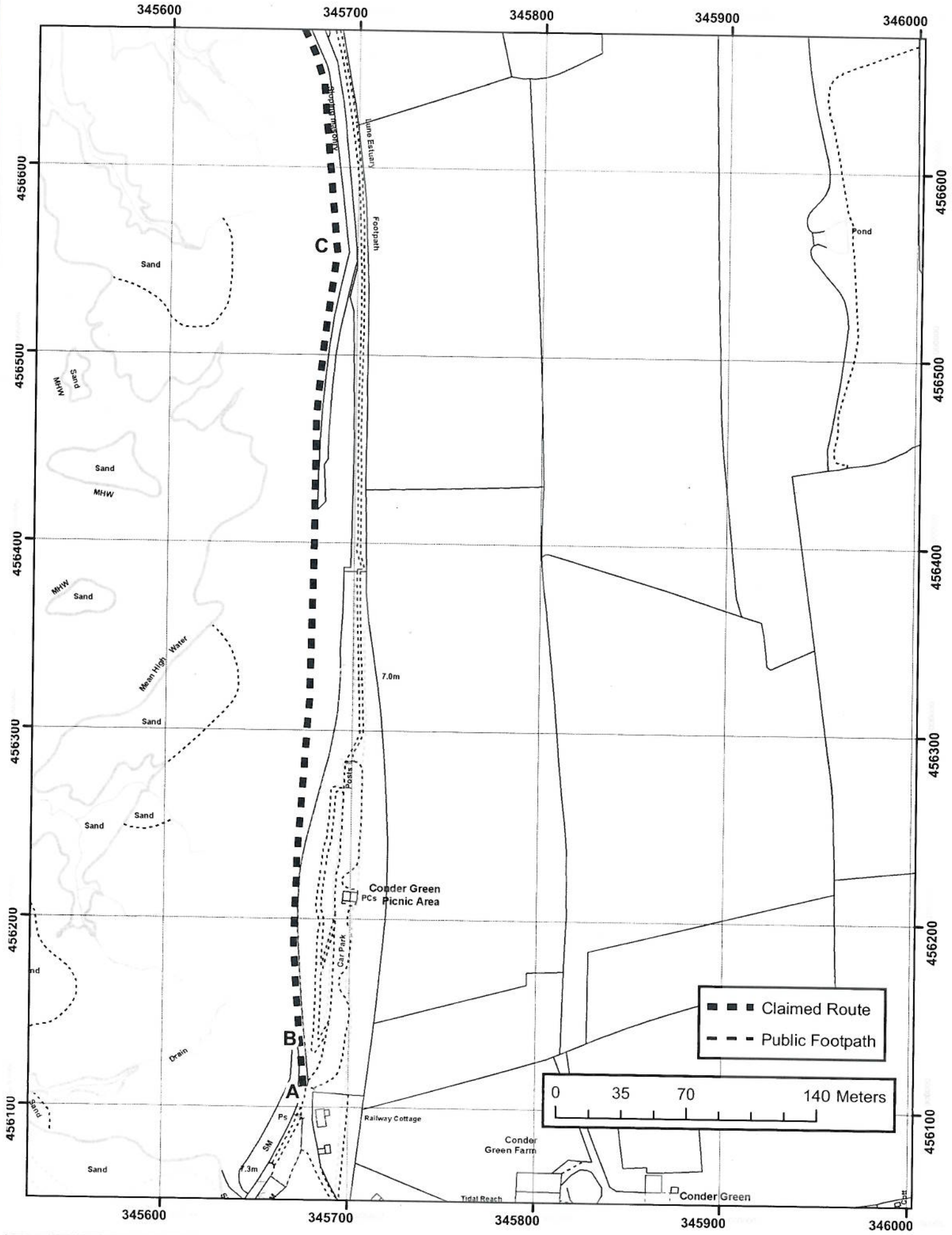

The digitised Rights of Way information should be used for guidance only as its accuracy cannot be guaranteed. Rights of Way information must be verified on the current Definitive Map before being supplied or used for any purpose.

This Map is reproduced from Ordnance Survey material with the permission of Ordnance Survey on behalf of the controller of Her Majesty's Stationery Office (C) Crown Copyright. Unauthorised reproduction infringes Crown Copyright and may lead to Prosecution or civil proceedings. Lancashire County Council Licence No. 100023320

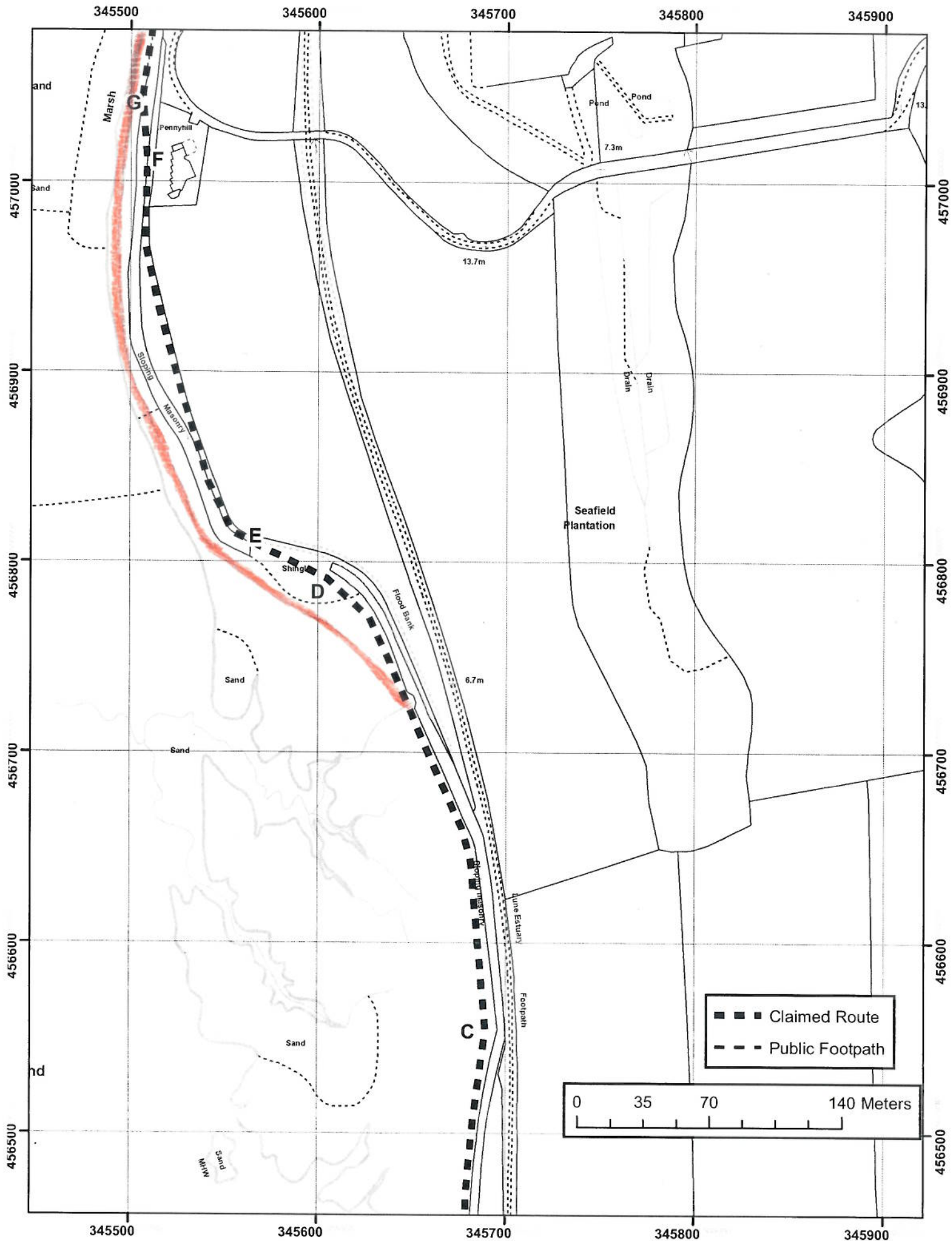

Jo Turton  
Executive Director  
for the Environment

Wildlife and Countryside Act 1981 Section 53  
Claimed public footpath from Conder Green to Nan Bucks Cottage, Thurnham, Lancaster District  
PLAN 2

1:2,500



The digitised Rights of Way information should be used for guidance only as its accuracy cannot be guaranteed. Rights of Way information must be verified on the current Definitive Map before being supplied or used for any purpose.

This Map is reproduced from Ordnance Survey material with the permission of Ordnance Survey on behalf of the controller of Her Majesty's Stationery Office (C) Crown Copyright. Unauthorised reproduction infringes Crown Copyright and may lead to Prosecution or civil proceedings. Lancashire County Council Licence No. 100023320

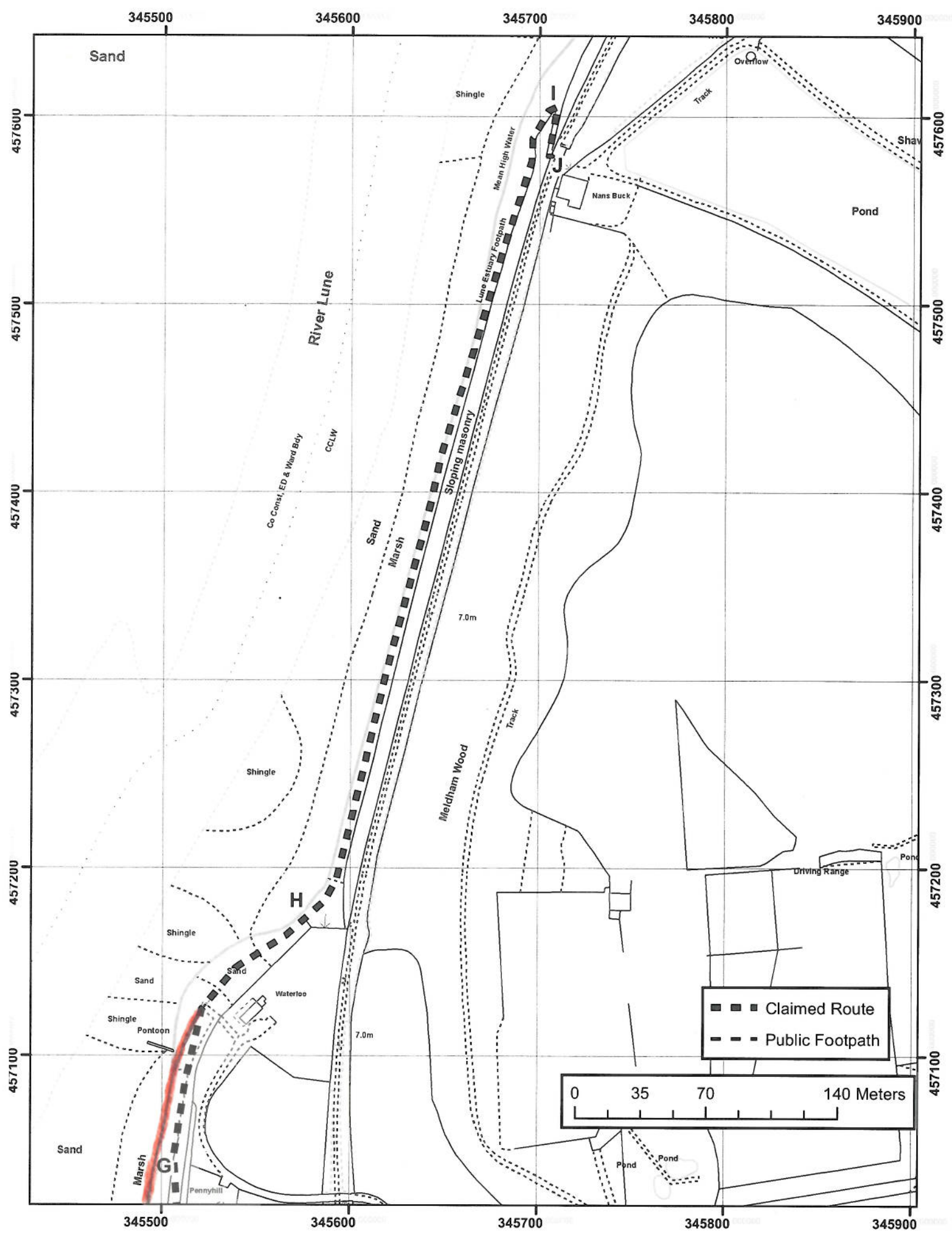

Jo Turton  
Executive Director  
for the Environment

Wildlife and Countryside Act 1981 Section 53  
Claimed public footpath from Conder Green to Nan Bucks Cottage, Thurnham, Lancaster District  
PLAN 3

1:2,500



The digitised Rights of Way information should be used for guidance only as its accuracy cannot be guaranteed. Rights of Way information must be verified on the current Definitive Map before being supplied or used for any purpose.

This Map is reproduced from Ordnance Survey material with the permission of Ordnance Survey on behalf of the controller of Her Majesty's Stationery Office (C) Crown Copyright.  
Unauthorised reproduction infringes Crown Copyright and may lead to Prosecution or civil proceedings. Lancashire County Council Licence No. 100023320