

Based on Ordnance Survey mapping with the permission of the Controller of Her Majesty's Stationery Office. Crown copyright. Unauthorised reproduction infringes Crown copyright and may lead to prosecution or civil proceedings.
Lancashire County Council Licence No. LA10023320

Ambleedene

Bus stop clearway - extent and position

Bus stop clearway box

Bus stop clearway box

Glendale
Lyndale

Brookside

Greenways

Mallards Walk

Preston Road

EL Sub Sta

27m

62m

27m

3m

Scale 1:500

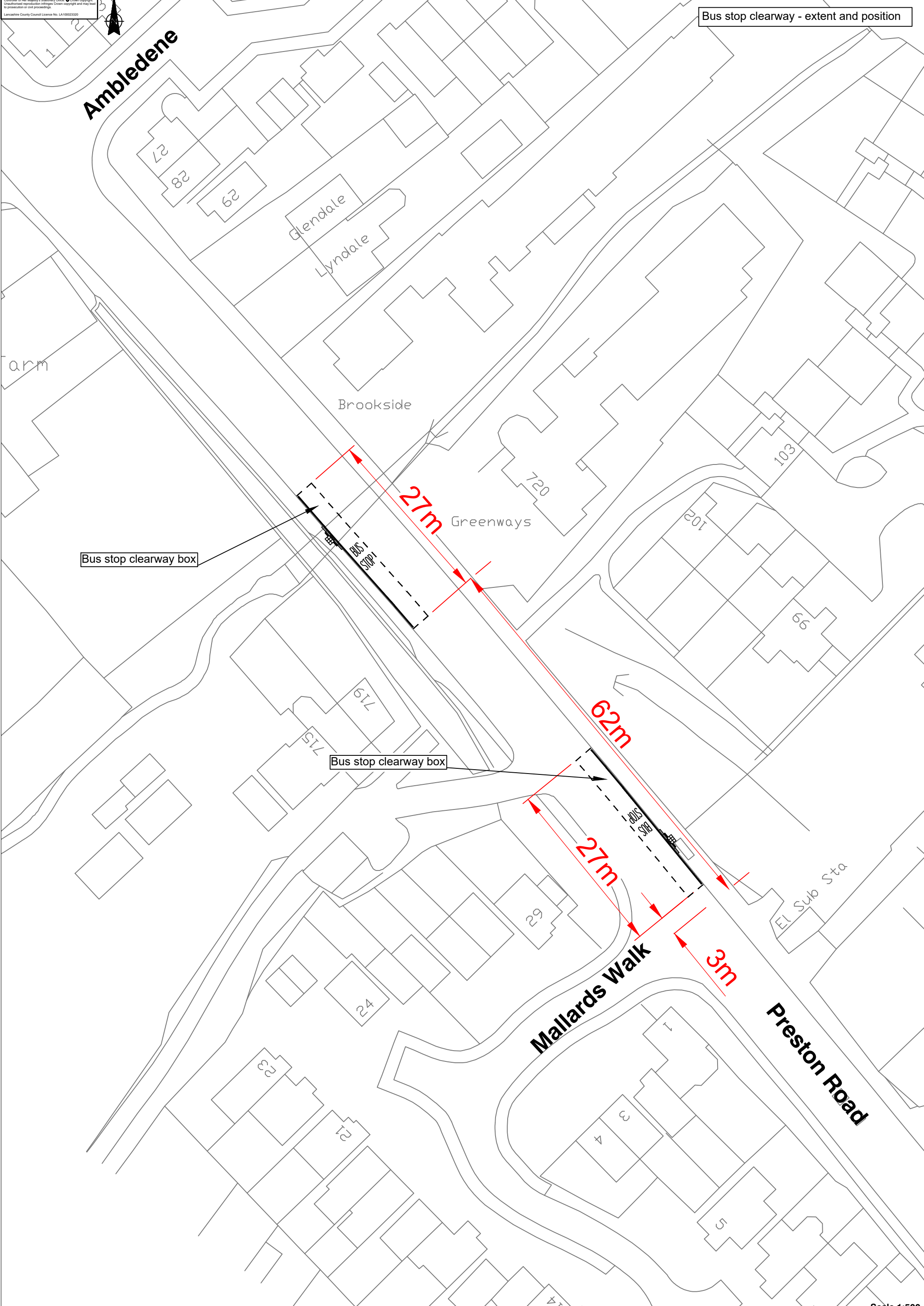

Based on Ordnance Survey mapping with the permission of the Controller of Her Majesty's Stationery Office. Crown copyright. Unauthorised reproduction infringes Crown copyright and may lead to prosecution or civil proceedings.
Lancashire County Council Licence No. LA10023320



Bus stop clearway - extent and position

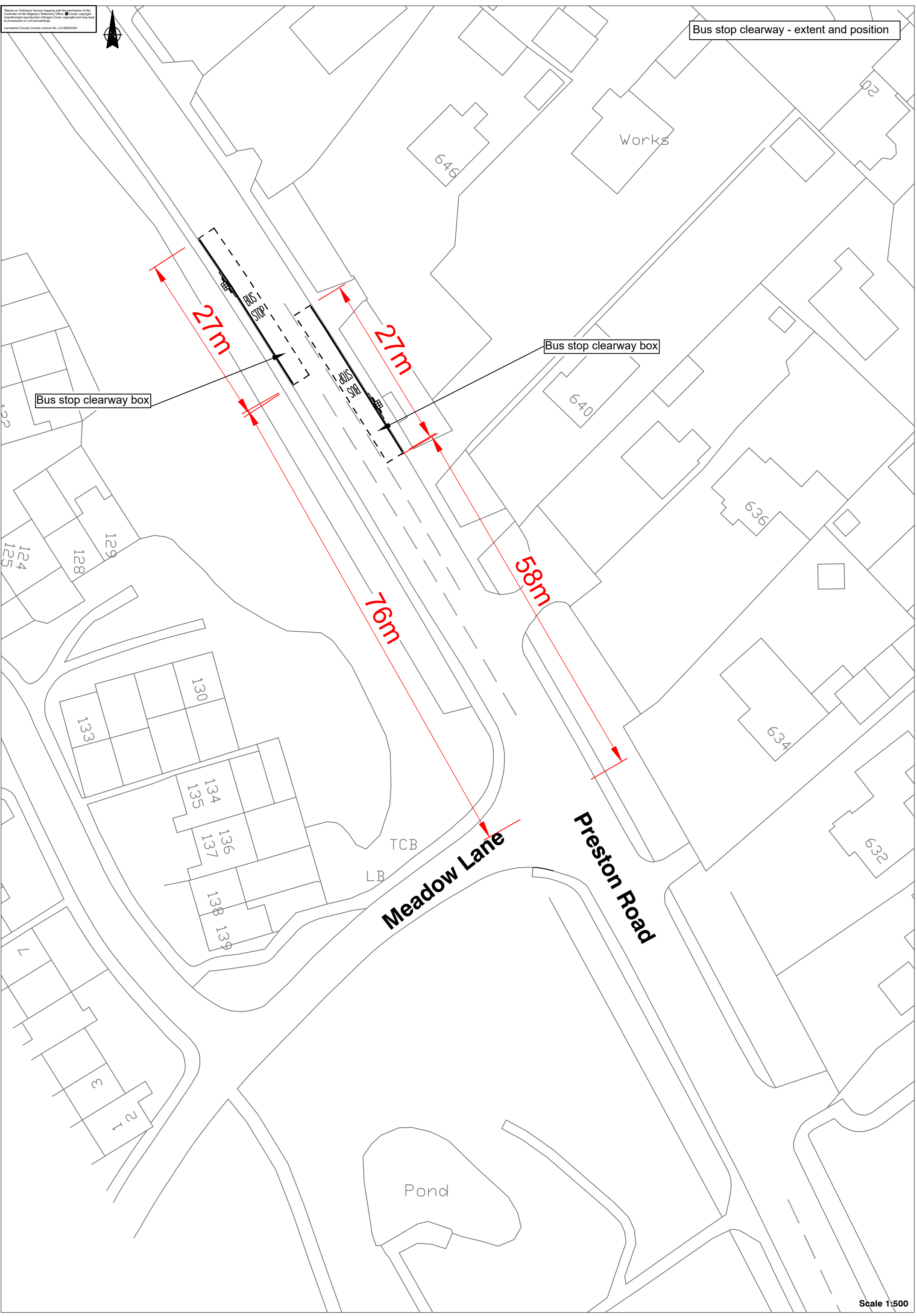

Based on Ordnance Survey mapping with the permission of the Controller of Her Majesty's Stationery Office. Crown copyright. Unauthorised reproduction infringes Crown copyright and may lead to prosecution or civil proceedings.
Lancashire County Council Licence No. LA10023320



Bus stop clearway - extent and position

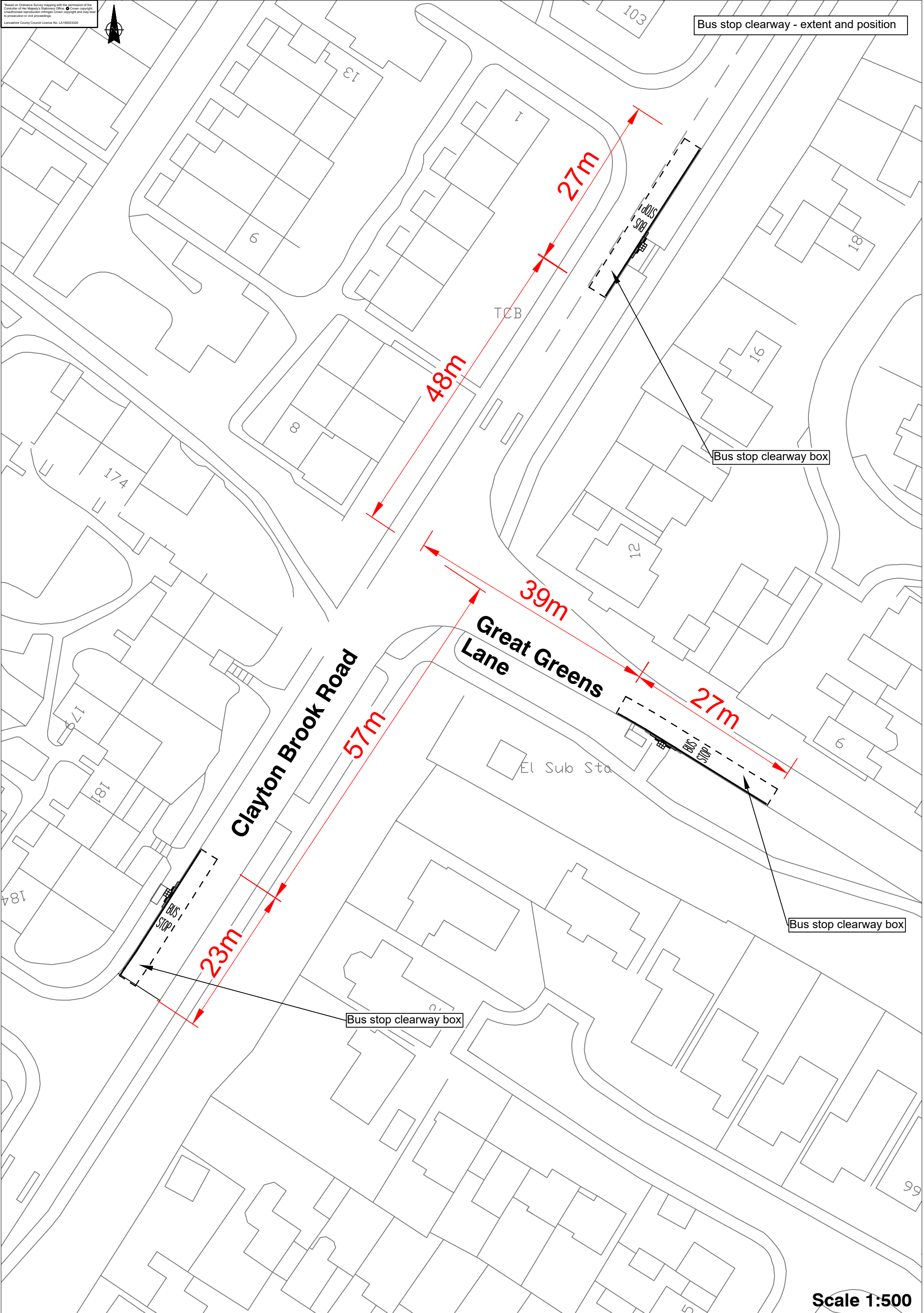

Scale 1:500

Based on Ordnance Survey mapping with the permission of the Controller of Her Majesty's Stationery Office. © Crown copyright. Unauthorised reproduction infringes Crown copyright and may lead to prosecution or civil proceedings.
Lancashire County Council License No. LA1002320



Bus stop clearway - extent and position

School Field

60m

36m

Bus stop clearway to Existing Layby

Sports Court

Hall

TCB LB

Bus stop clearway to Existing Layby

42m

62m Great Greens Lane

chool

Health Centre

Clinic

64 Surgery

65 to 77

76

74

Car Park

70

73

TUNLEY HOLME

Tunley Holme

Scale 1:500

Based on Ordnance Survey mapping with the permission of the
Controller of Her Majesty's Stationery Office. Crown copyright.
Unauthorised reproduction infringes Crown copyright and may lead
to prosecution or civil proceedings.
Lancashire County Council Licence No. LA10023200



Bus stop clearway - extent and position

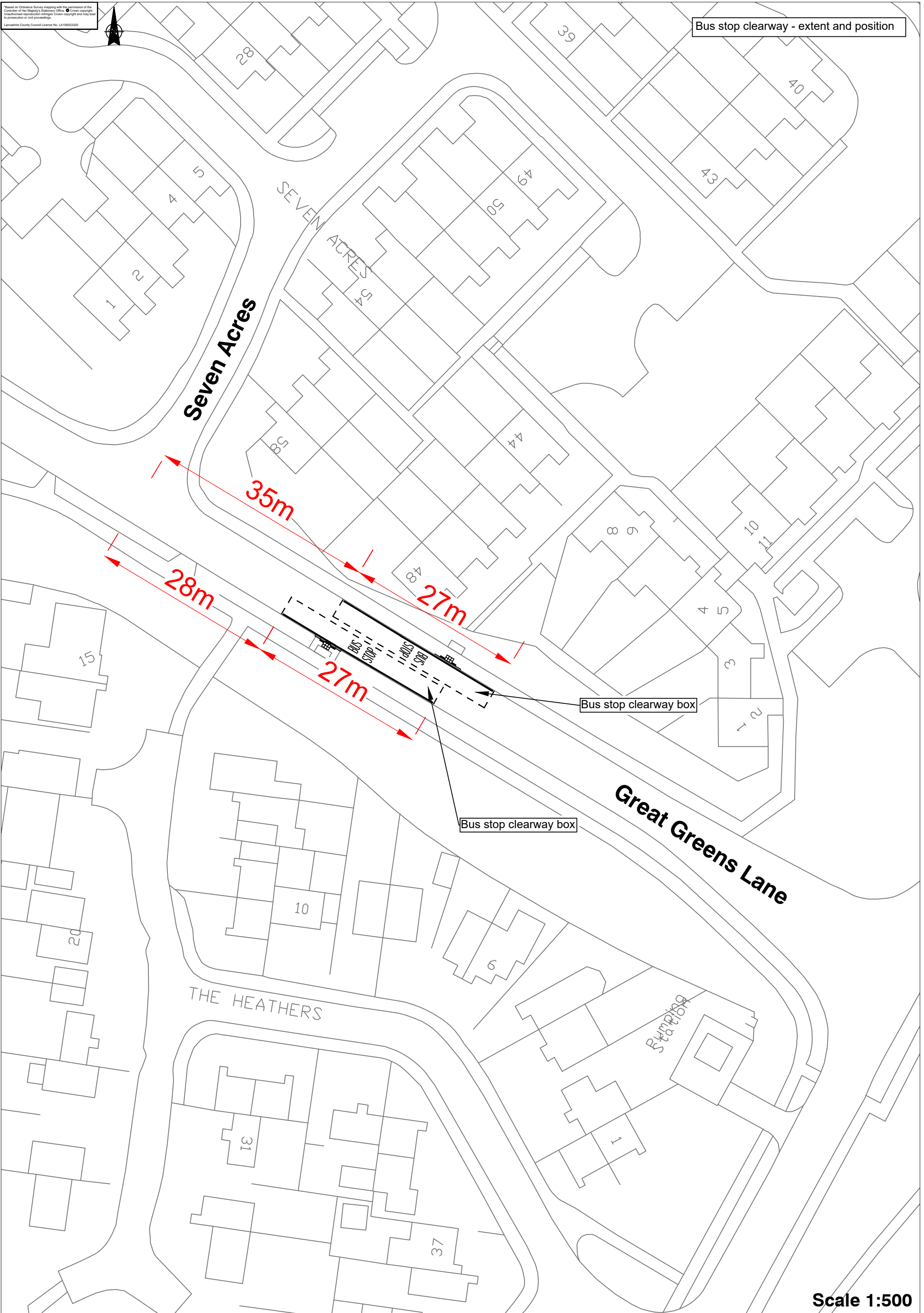

Scale 1:500

Based on Ordnance Survey mapping with the permission of the Controller of Her Majesty's Stationery Office. © Crown copyright. Unauthorised reproduction infringes Crown copyright and may lead to prosecution or civil proceedings. Lancashire County Council License No. LA1002320



Existing Bus stop clearway - extent and position

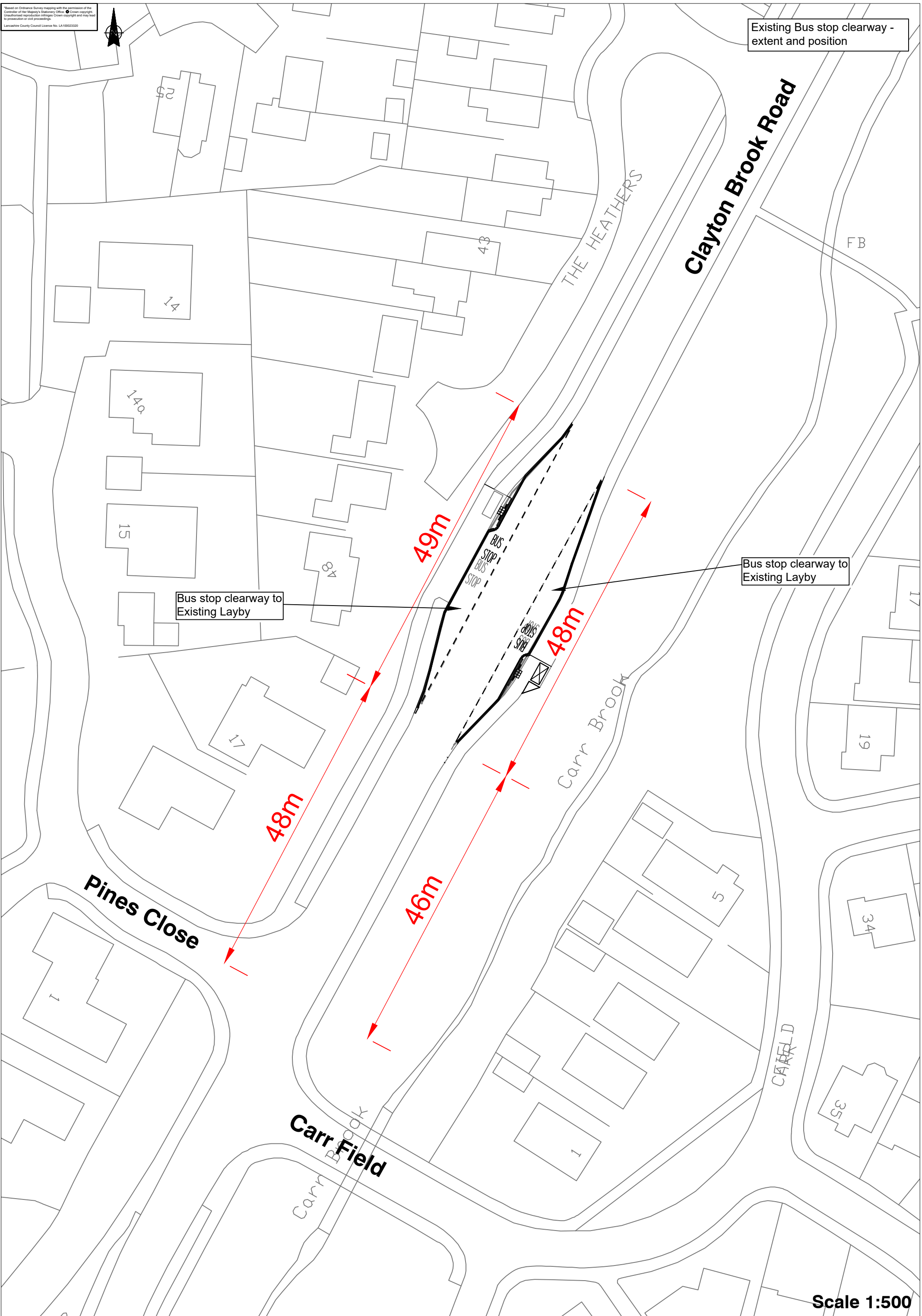

Bus stop clearway to Existing Layby

Bus stop clearway to Existing Layby

Scale 1:500



Existing Bus stop clearway removed - extent and position

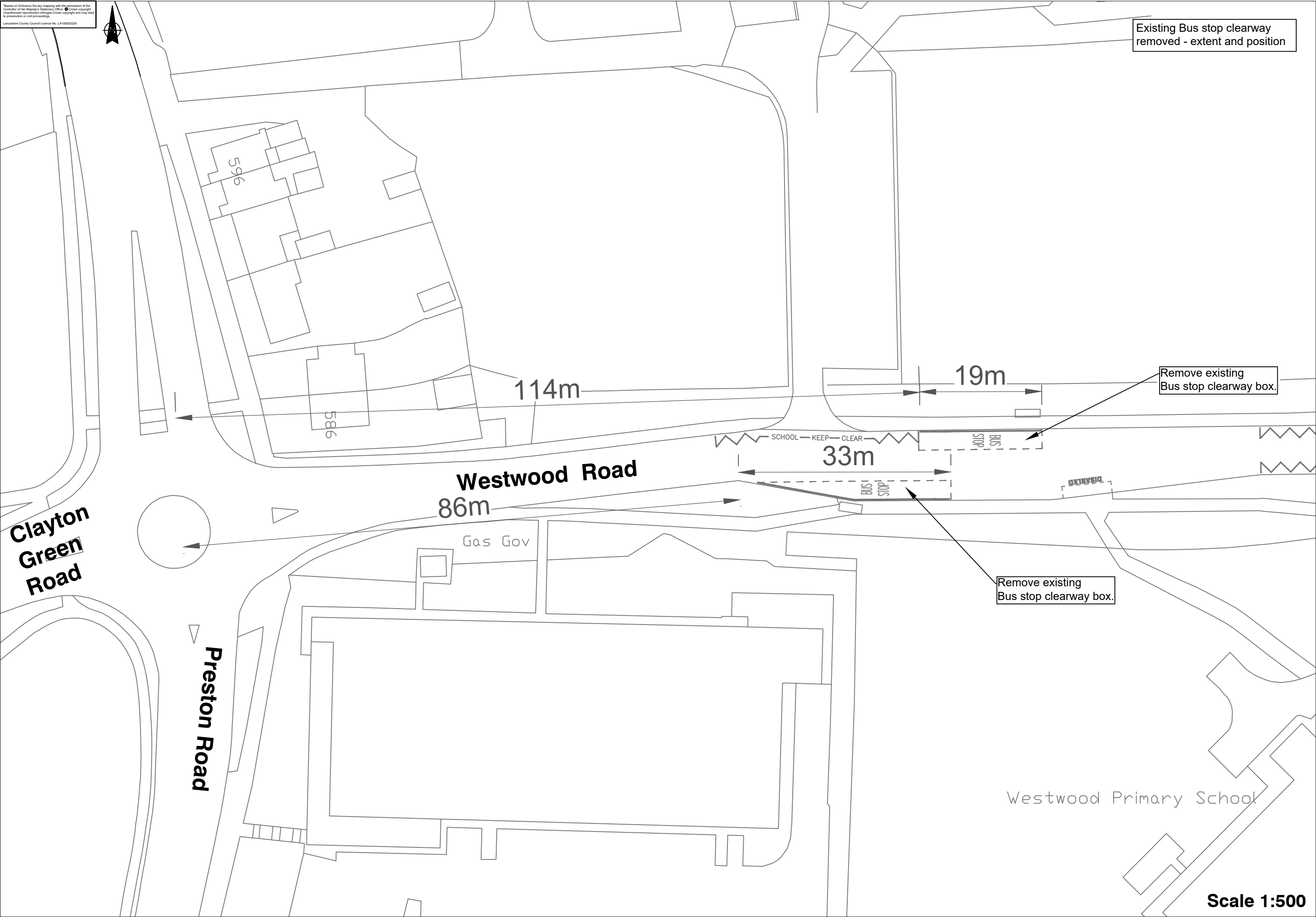

Clayton Green Road

Preston Road

Westwood Road

Westwood Primary School

Scale 1:500

114m

86m

33m

19m

SCHOOL KEEP CLEAR

BUS STOP

DISABLED

Remove existing Bus stop clearway box.

Remove existing Bus stop clearway box.

596

586

Gas Gov



Bus stop clearway - extent and position

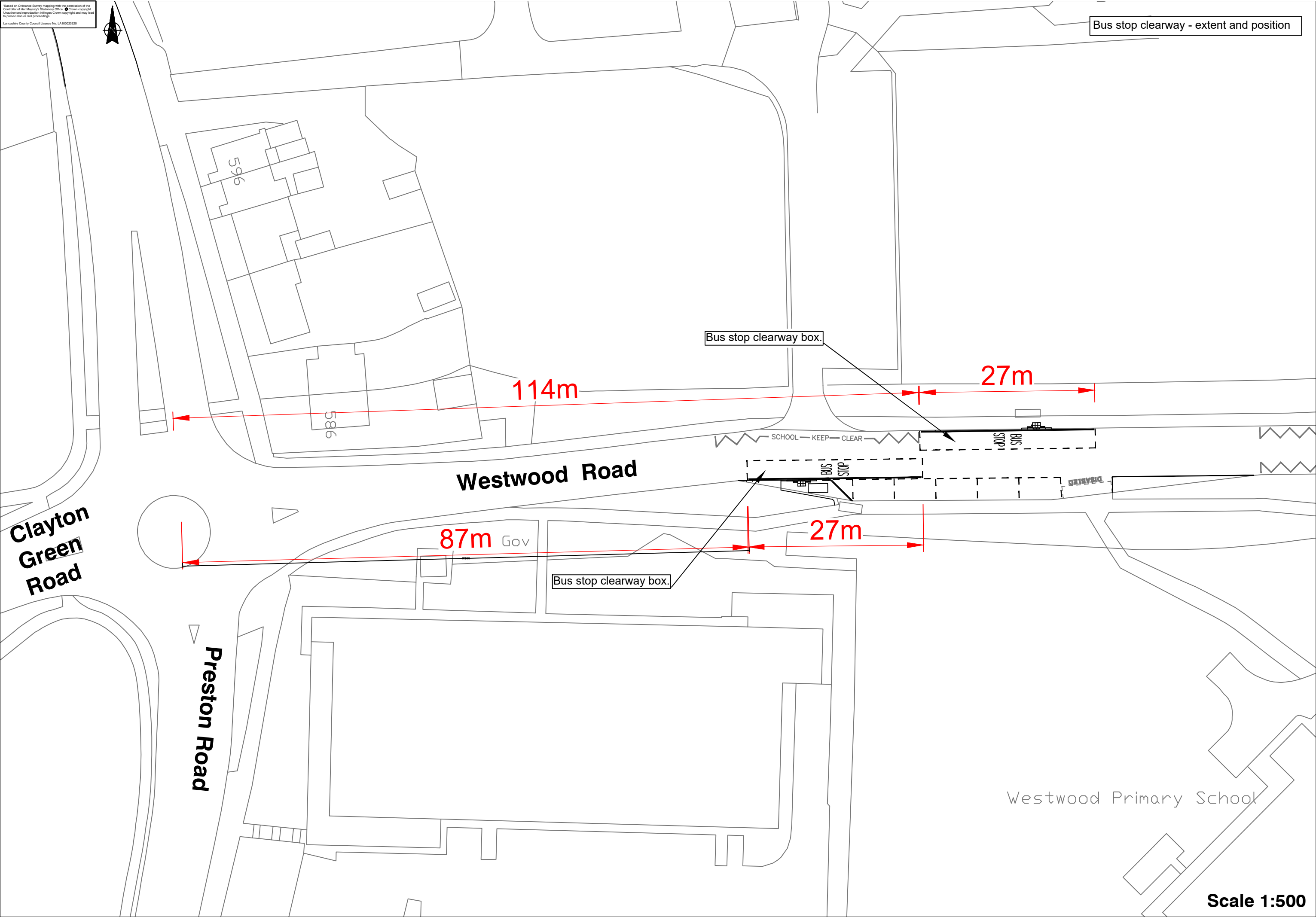

Based on Ordnance Survey mapping with the permission of the Controller of Her Majesty's Stationery Office. Crown copyright. Unauthorised reproduction infringes Crown copyright and may lead to prosecution or civil proceedings.
Lancashire County Council Licence No. LA10023320



Bus stop clearway - extent and position

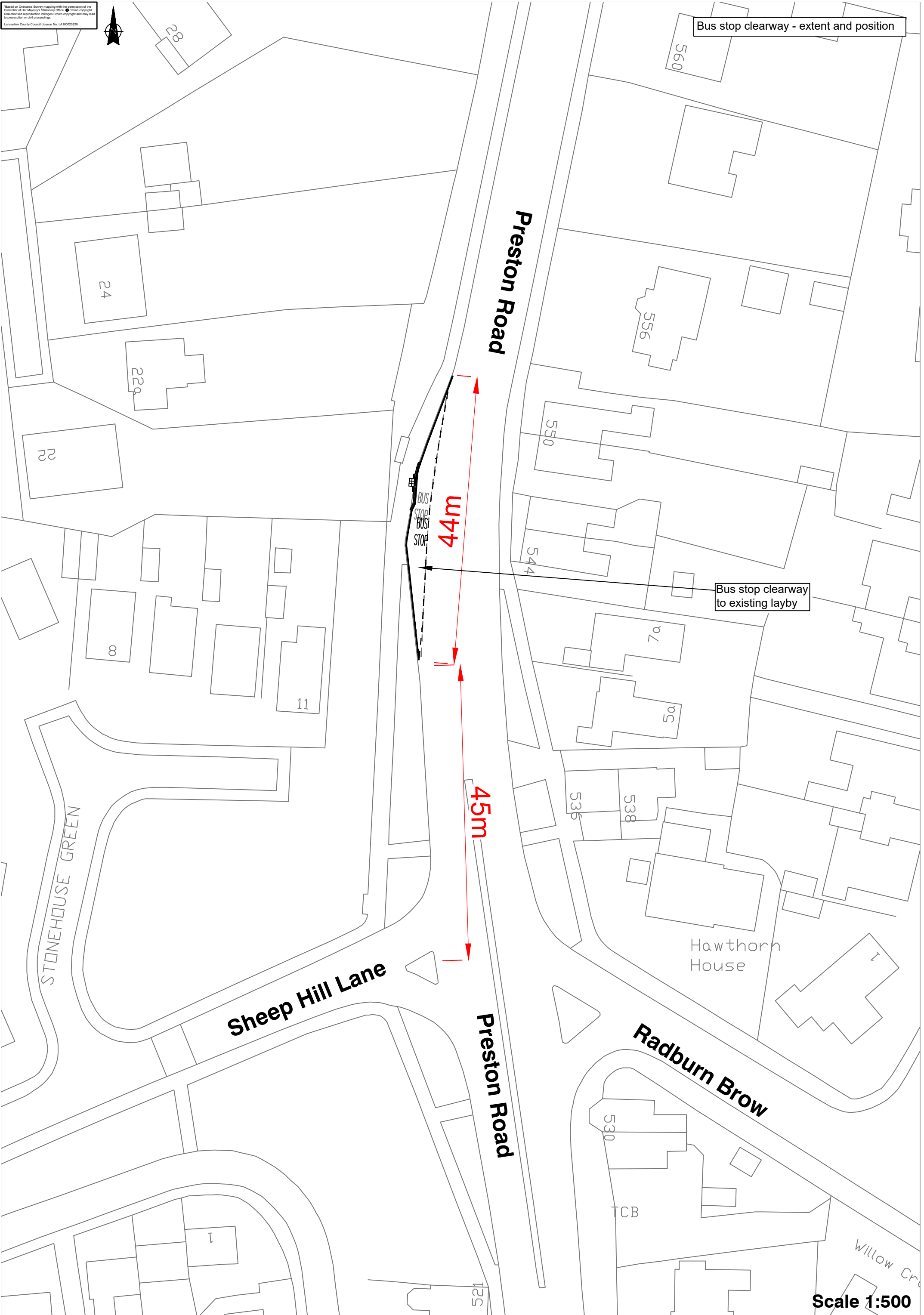

Scale 1:500