

WILDLIFE AND COUNTRYSIDE ACT 1981

THE DEFINITIVE MAP AND STATEMENT OF PUBLIC RIGHTS OF WAY FOR THE  
COUNTY OF LANCASHIRE

THE LANCASHIRE COUNTY COUNCIL (THWAITE BROW LANE, BOLTON-LE-  
SANDS) DEFINITIVE MAP MODIFICATION ORDER 2018

This Order is made by Lancashire County Council ("the Authority") under Section 53(2)(b) of the Wildlife and Countryside Act, 1981 ("the Act") because it appears to that authority that The Definitive Map and Statement of Public Rights of Way for the County of Lancashire require modification in consequence of the occurrence of an event specified in Section 53(3)(c)(i) of the Act, namely the discovery by the authority of evidence which (when considered with all other relevant evidence available to them) shows that a right of way which is not shown in the map and statement subsists or is reasonably alleged to subsist over land in the area to which the map relates, namely a byway open to all traffic.

The authority have consulted with every local authority whose area includes the land to which the order relates. Lancashire County Council hereby order that:

1. For the purposes of this order, the "relevant date" is 4<sup>th</sup> July 2018.
2. The Definitive Map and Statement of Public Rights of Way for the County of Lancashire shall be modified as described in Part I and Part II of the Schedule and shown on the map attached to the Order.
3. This order shall take effect on the date it is confirmed and may be cited as The Lancashire County Council (Thwaite Brow Lane, Bolton-le-Sands) Definitive Map Modification Order 2018.

Dated this 4<sup>th</sup> day of July 2018.

THE COMMON SEAL of the )  
Lancashire County Council )  
was hereunto affixed in the presence of )

Authorised Signatory



27184

SCHEDULE

PART I

MODIFICATION OF THE DEFINITIVE MAP

DESCRIPTION OF PATH OR WAY TO BE ADDED

Byway Open to All Traffic (commonly known as Thwaite Brow Lane) from the junction with Mount Pleasant Lane and Highfield Lane (point A on the Order Map) generally west along a bounded track passing through Crawstone Wood then north on an unbounded track through Thwaite Brow Woods to a junction of Whin Grove and Thwaite Brow Lane (U3529) (point C); a total distance of approximately 480 metres and at a width varying between 2.5 and 4 metres, shown on the Order Map as a continuous brown line marked A-B-C.

PART II

MODIFICATION OF DEFINITIVE STATEMENT

VARIATION OF PARTICULARS OF PATH OR WAY

Entry to be added to read as follows:

"Byway open to all traffic commencing from the cross roads of Mount Pleasant Lane, Highfield Lane and Thwaite Brow Lane at SD 4906 6864 and running in a generally westerly direction along a bounded track passing through Crawstone Wood to SD 4879 6866 from where it enters Thwaite Brow Woods and continues as an unbounded track in a generally northerly direction to the junction of Whin Grove and Thwaite Brow Lane (U3529) at SD 4880 6884."

Width:

SD 4906 6864 to SD 4879 6866: Varies between 3 and 4 metres as shown on Ordnance Survey 25 inch sheets XXIV.11 and XXIV.12 both surveyed 1889 and published 1891.

SD 4879 6866 to SD 4880 6884: Varies between 2.5 and 4 metres as shown on Ordnance Survey 25 inch sheets XXIV.11 and XXIV.12 both surveyed 1889 and published 1891.

Length: "0.48 km"

Other particulars:

Limitations:

Field gate: SD 4879 6866

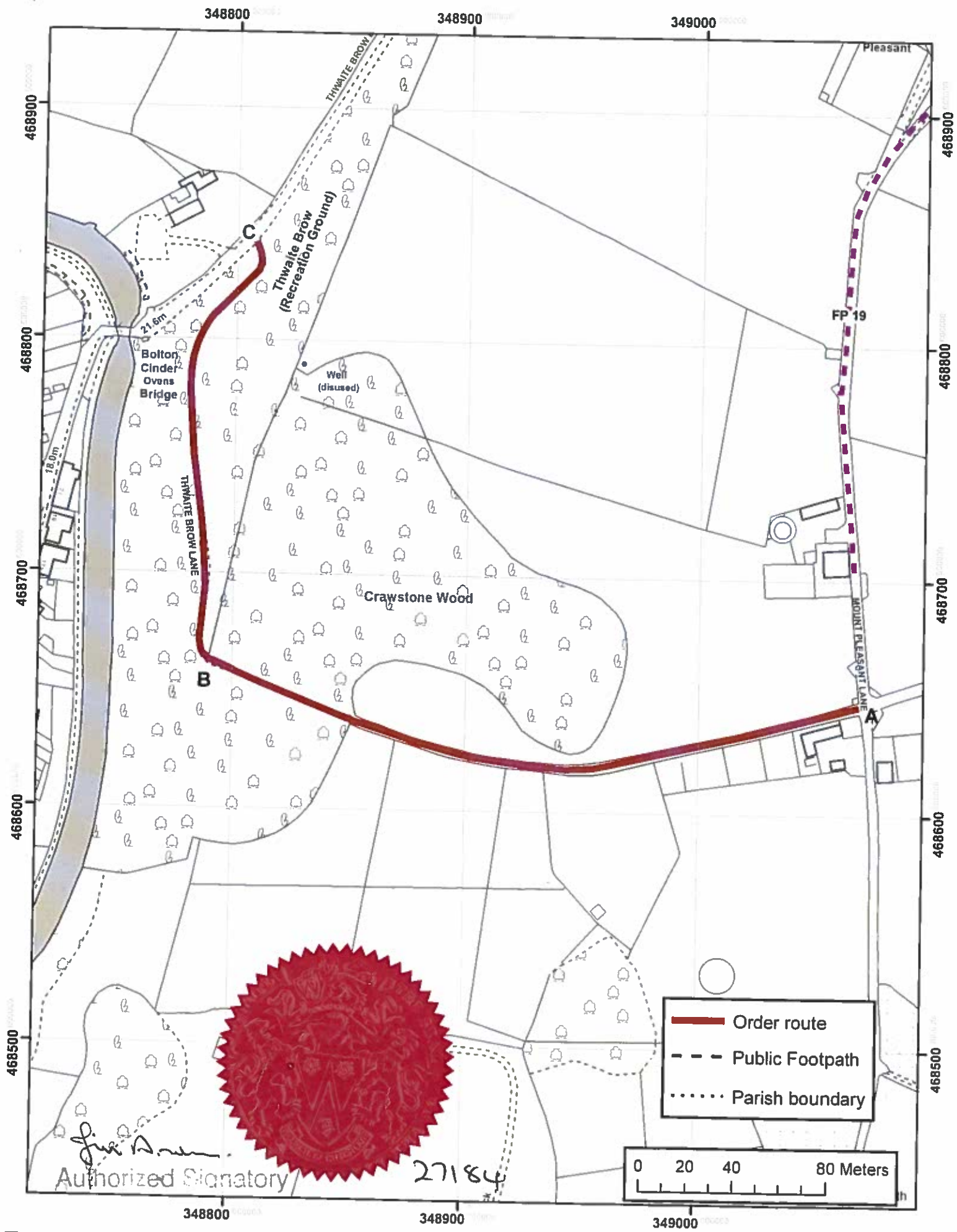

*John A. ...*  
 Authorized Signatory

27184

	<p><b>Andrew Mullaney</b>        Head of Planning and Environment</p>	<p>Wildlife and Countryside Act 1981        Addition of part of Thwaite Brow Lane, Bolton le Sands,        in the District of Lancaster as a Byway Open to All Traffic</p>	<p>1:2,000</p>	
<p>The digitised Rights of Way information should be used for guidance only as its accuracy cannot be guaranteed. Rights of Way information must be verified on the current Definitive Map before being supplied or used for any purpose.</p>				
<p>This Map is reproduced from Ordnance Survey material with the permission of Ordnance Survey on behalf of the controller of Her Majesty's Stationery Office (C) Crown Copyright. Unauthorised reproduction infringes Crown Copyright and may lead to Prosecution or civil proceedings. Lancashire County Council Licence No. 100023320</p>				