

Extract from the Finance Act Map obtained from The National Archives



BURY

LXXXVIII. I. N.W.

LANCASHIRE. SHEET LXXXVIII. I. S. W.

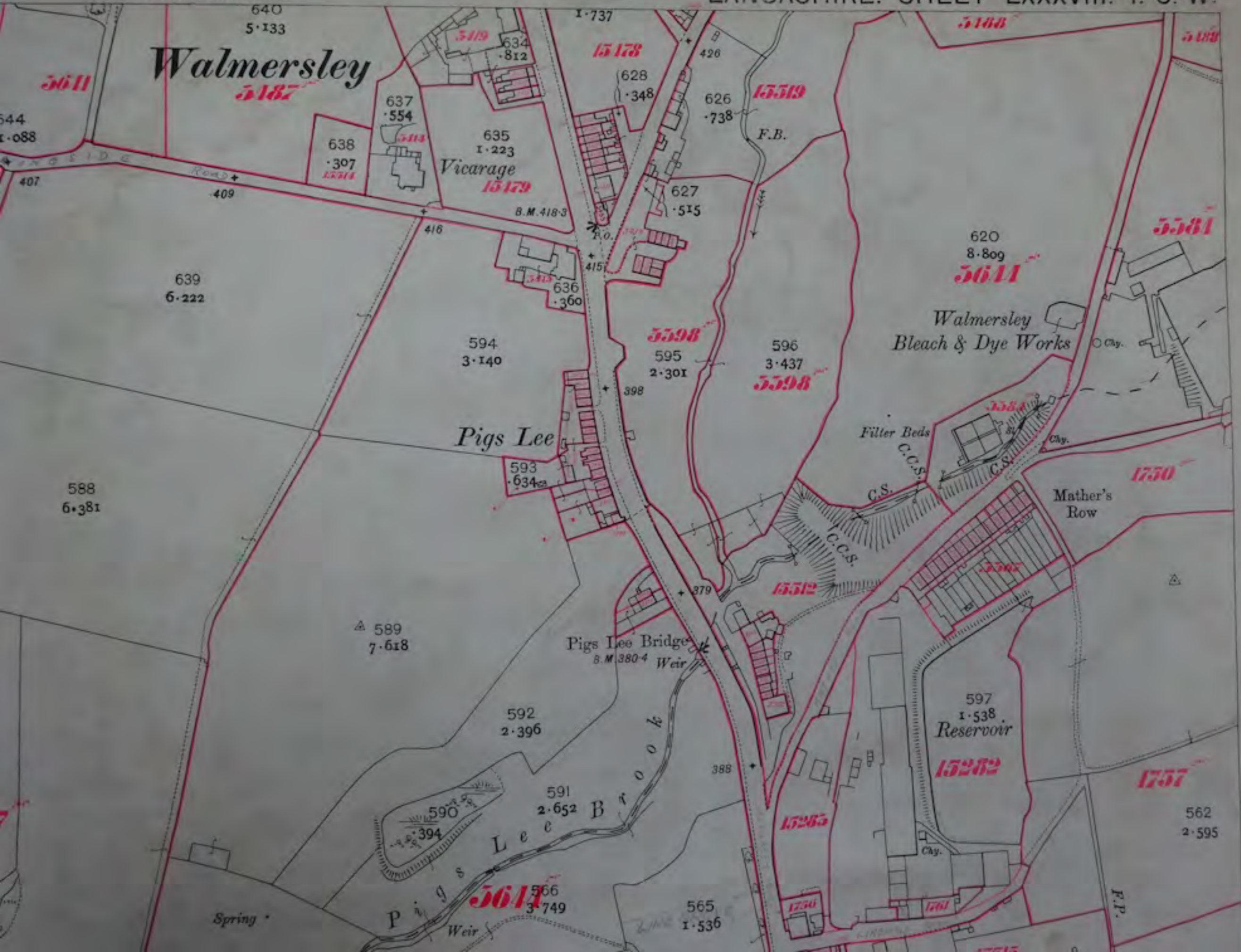

Walmersley

Vicarage

Pigs Lee

Walmersley Bleach & Dye Works

Pigs Lee Bridge

Reservoir

Mather's Row

5111
5187

638
307
15211

635
1223
15179

15178

15519

5111

5598

5598

5588

1750

15512

5567

589
7618

592
2396

591
2652

597
1538

1757

562
2595

566
3749

565
1536

15265

15282

1757

Spring

Pigs Lee Weir

1750

1761

17515

F.P.

Whitewall Wood

Hydraulic Ram

12

WALMERLEY

Und. 88
-270

92
1.815

94
554

ROAD

1238
223
air

15473
GUY

93
1.442

87
1.065

15473

720
600

82
1.584

81
6.352

Gindles

F.W.

85
756

2.526

84
962

4.347

86

83

F.P.

55

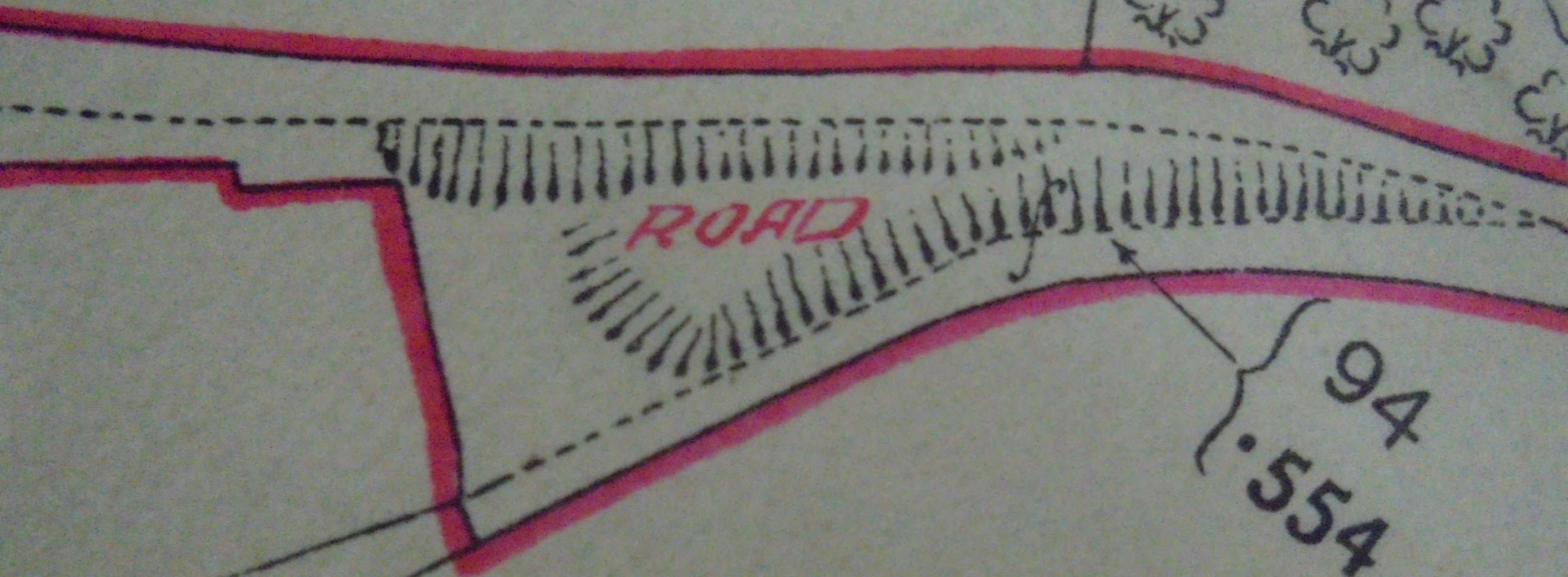
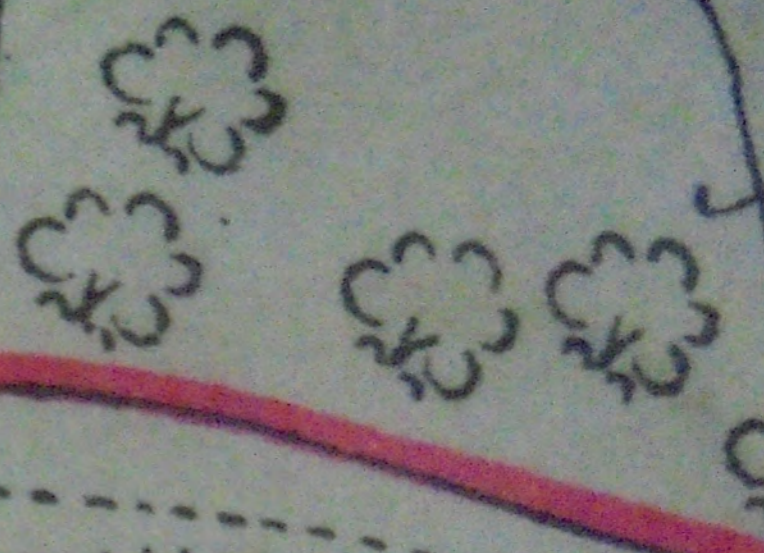

ROAD

94
.554