

TO CLOSE A TRUST.

FOULRIDGE NEAR COLNE

LANCASHIRE.

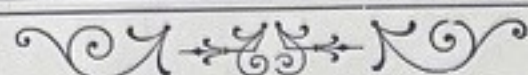

PARTICULARS AND CONDITIONS OF SALE

OF A

VALUABLE

FREEHOLD ESTATE

CONSISTING OF

FARMS, ACCOMMODATION LANDS,

AND

BUILDING SITES,

WHICH WILL BE

SOLD BY AUCTION BY MR. MATTHEW WATSON,

AT THE

CROWN HOTEL, COLNE, LANCASHIRE,

ON

WEDNESDAY the 29th day of APRIL, 1903,

AT TWO O'CLOCK PRECISELY.

The Property may be viewed by permission of the respective Occupiers, and Particulars and Conditions of Sale with Plans may be obtained from the Auctioneer, Mr. Matthew Watson, 4, Nicholas Street, Burnley; at the Crown Hotel, Colne; or from

Messrs. PARKER & PARKER,

SOLICITORS,

SELBY, YORKSHIRE.



SALE PLAN

OF
BALL HOUSE FARM, REEF EDGE AND SPOIL BANK, &c.,

SITUATE AT

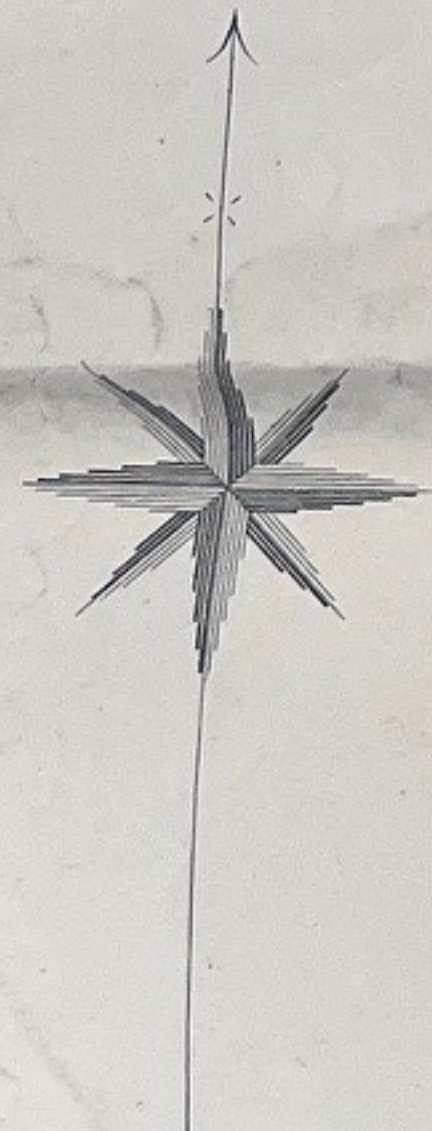
FOULRIDGE.



REMARKS.
The Fence is made by that side on which
is placed this mark, thus: 
Footpaths are shewn thus: 

PARKER & PARKER.
SOLICITORS.
SELBY.

SCALE 208.33 FEET TO ONE INCH.

MATTHEW WATSON,
SURVEYOR,
BURNLEY.
1903.

REPRODUCED FROM THE ORDNANCE SURVEY MAP WITH THE
SANCTION OF THE CONTROLLER OF H.M. STATIONERY
OFFICE.

— SALE PLAN —

OF
BALL HOUSE FARM, REEF EDGE AND SPOIL BANK, &c.

SITUATE AT

FOULRIDGE.



REMARKS.
The Fence is made by that side on which
is placed this mark, thus: ————
Footpaths are shewn thus: - - - - -

PARKER & PARKER,
SOLICITORS,
SELBY.

SCALE 208'33 FEET TO ONE INCH.

MATTHEW WATSON,
SURVEYOR,
BURNLEY,
1903.

REPRODUCED FROM THE ORDNANCE SURVEY MAP WITH THE
SANCTION OF THE CONTROLLER OF H.M. STATIONERY
OFFICE.

TO CLOSE A TRUST.

FOULRIDGE, NEAR COLNE,
LANCASHIRE.

Particulars and Conditions of Sale

OF A

VALUABLE

FREEHOLD ESTATE

CONSISTING OF

FARMS

ACCOMMODATION LANDS,

AND

BUILDING SITES,

WHICH WILL BE

SOLD BY AUCTION,

BY

MR. MATTHEW WATSON,

AT THE CROWN HOTEL, COLNE,

(LANCASHIRE),

On **WEDNESDAY, 29th April, 1903,**

AT TWO O'CLOCK PRECISELY.

PARKER & PARKER,

SOLICITORS, SELBY.

H. M. SPENCER, PRINTER, FINKLE STREET, SELBY.

PARTICULARS.

LOT 1. THE BALL HOUSE FARM. Edged Green on the Plan.

| No. ON ORDNANCE SURVEY. | DESCRIPTION. | TENANT'S NAME. | CULTIVATION. | QUANTITY. | | | |
|-------------------------------|---|-------------------|--------------|-----------|----|----|----|
| | | | | A. | R. | P. | |
| Pt 218 | House and Garden, Barn and Shippon | Mr. James Goodwin | | | | | |
| | Croft | | Pasture ... | | | | |
| 218 | Far House Field ... } now in one | Ditto | " ... | 12 | 2 | 20 | |
| | Near House Field ... | | " ... | | | | |
| 168 | High Bull Coppy and Out Bull Coppy | Ditto | " ... | 13 | 3 | 1 | |
| 174 | Little Bull Coppy | Ditto | " ... | 3 | 2 | 23 | |
| 175 | Bull Coppy | Ditto | " ... | 6 | 2 | 35 | |
| 177 | Pasture | Ditto | " ... | 4 | 1 | 22 | |
| 230 | Sandhole Hill and Big Meadow | Ditto | Meadow ... | 10 | 2 | 28 | |
| 231 | Carr Field | Ditto | Pasture ... | 4 | 2 | 24 | |
| 232 | Carr Meadow | Ditto | Meadow ... | 2 | 1 | 38 | |
| | | | | A. | 58 | 3 | 31 |

This lot is sold subject to Land Tax and Tithe commuted value 12/2, present value 8/2.

LOT 2.—Edged Pink on Plan.

| | | | | | | | |
|-----|---------------------|-------------------|------------|----|---|----|---|
| 267 | Long Meadow | Mr. James Goodwin | Meadow ... | 1 | 2 | 35 | |
| 265 | Butts Meadow | Ditto | Ditto | 4 | 1 | 13 | |
| | | | | A. | 6 | 0 | 8 |

This lot is sold subject to Land Tax

LOT 3.—Edged Yellow on Plan.

| | | | | | | |
|-----|------------------|-------------------|------------|---|---|----|
| 182 | Reef Edge | Mr. Abner Barrett | Meadow ... | 2 | 3 | 21 |
|-----|------------------|-------------------|------------|---|---|----|

This lot is sold subject to Land Tax

LOT 4.—Edged Pink on Plan.

| | | | | | | |
|--|--|-----------------------|--|--|--|--------------------------------|
| | Farmhouse, Cottage, Barn, Shippon, Cart Shed, &c. | Mr. Richard Sutcliffe | | | | 809 $\frac{1}{2}$ square yards |
| | This lot is sold subject to Land Tax | | and Tithe commuted value 15/1, present value 10/2. | | | |

LOT 5.—Edged Pink on Plan.

| | | | | | | | |
|-----|--------------------------------------|-----------------------|-------------|----|----|----|---|
| 247 | Lower Parrock and Great Rough | Mr. Richard Sutcliffe | Pasture ... | 14 | 1 | 24 | |
| 200 | Plantation | Ditto | | - | 1 | 22 | |
| | | | | A. | 14 | 3 | 6 |

This lot is sold subject to Land Tax and Tithe commuted value 6d., present value 4d.

LOT 6.—Edged Pink on Plan.

| | | | | | | | |
|-----|-----------------------------------|----------------------|-------------|----|----|----|----|
| 388 | Plantation | Mr. Ishmael Stuttard | | 1 | 0 | 8 | |
| 389 | Noyna Field and Noyna Hill | Ditto | Pasture ... | 13 | 0 | 31 | |
| 390 | Plantation | Ditto | | - | 2 | 21 | |
| | | | | A. | 14 | 3 | 20 |

This lot is sold subject to Land Tax

LOT 7.
NOYNA OUTWITH, OR NOYNA BOTTOM FARM.
 Edged Blue on Plan.

| No. ON ORDNANCE SURVEY. | DESCRIPTION. | TENANT'S NAME. | CULTIVATION. | QUANTITY. | | | |
|-------------------------------|---|----------------------|--------------|-----------|----|----|----|
| | | | | A. | R. | P. | |
| Pt 393 | Farmhouse, Barn, Shippon, Yard, &c. | Mr. Ishmael Stuttard | | | | | |
| Pt 377 | Calhouse, Piggeries, &c., and site of Tank | Ditto | | 1 | 0 | | |
| 393 | Plantation | Mr. John Webster | | | | | |
| 394 | Noyna Hill | Ditto | Pasture ... | 17 | 3 | 39 | |
| 395 | Plantation | Ditto | | | 3 | 18 | |
| 398 | Plantation | Ditto | | 1 | 1 | 27 | |
| 399 | Noyna Hill | Ditto | Ditto | 2 | 2 | 22 | |
| 400 | Great Wood | Ditto | Ditto | 18 | 2 | 36 | |
| 401 | Noyna Field | Mr. Marmaduke Green | Ditto | 8 | 0 | 29 | |
| 379 | Higher Field | Ditto | Ditto | 4 | 3 | 2 | |
| 370 | Middle Field | Ditto | Ditto | 4 | 0 | 25 | |
| 359 | Lower Field | Ditto | Ditto | 3 | 0 | 21 | |
| 378 | Driver Ing | Mr. Ishmael Stuttard | Ditto | 4 | 1 | 17 | |
| 371 | Plantation | Ditto | | | 1 | 16 | |
| 372 | Moss | Ditto | Meadow ... | 3 | 3 | 23 | |
| 358 | East Field | Ditto | Pasture ... | 3 | 1 | 22 | |
| | | | | A. | 74 | 1 | 15 |

This lot is sold subject to Land Tax and Tithe commuted value 12/2, present value 8/1.

LOT 8.
THE WHITE AND MOSS HOUSES FARM.
 Edged Yellow on the Sale Plan.

| | | | | | | | |
|--------|--|----------------------|-------------|----|----|----|----|
| Pt 361 | Farmhouse, Barn, Shippon, &c., called "White House" | Mr. Marmaduke Green | | 3 | 0 | 20 | |
| 361 | Meadow | Ditto | Meadow | | | | |
| 337 | Middle Meadow | Ditto | Ditto | 1 | 1 | 1 | |
| 347 | Middle Meadow | Ditto | Ditto | 2 | 0 | 23 | |
| Pt 349 | Cottage and Buildings called "Moss House" | Mr. John B. Lund ... | | | | | |
| 349 | Lowfield Plantation and Lower Jenkin now in one | Ditto | Pasture ... | 10 | 0 | 15 | |
| 348 | Higher Jenkin | Ditto | Meadow ... | 4 | 0 | 17 | |
| 357 | Plantation | Ditto | Pasture ... | | 2 | 22 | |
| | | | | A. | 21 | 1 | 18 |

This lot is sold subject to Land Tax and Tithe commuted value 2/10, present value 1/11.

LOT 9.
THE HIGHER CLOUGH FARM.
 Edged Pink on Plan.

| | | | | | | | |
|--------|--|-----------------|-------------|----|----|----|-------|
| Pt 336 | Farmhouse and Buildings | Mr. John Wilson | Pasture ... | 9 | 1 | 39 | |
| 336 | Long Meadow } Great Meadow } now in one Little Meadow } | | | | | | |
| 333 | Gill Field | | | | | | Ditto |
| 332 | Hole House Field | Ditto | | 3 | 1 | 20 | |
| 330 | Plantation | Ditto | | | 3 | 14 | |
| 334 | Rough | Ditto | | 3 | 2 | 3 | |
| | | | | A. | 21 | 0 | 18 |

Together with such rights of Boating and Fishing and use of Boathouse as belong to or are used and enjoyed by the Vendors in that portion of the new Reservoir as lies to the East of the Brownhill road.

This lot is sold subject to Land Tax and Tithe commuted value 5/11, present value 4/2.

13.—Documents of Title in the possession of the Vendors relating to several lots sold to different purchasers will be delivered to the purchaser whose purchase money is the highest after the sale of all the lots have been completed and will in the meantime be retained by the Vendors. The Vendors will as to the documents so retained give to every purchaser of property to which the same relate the usual statutory acknowledgment in respect thereof but not any undertaking for their safe custody. The purchaser to whom any documents shall be delivered which relate not only to the lot or lots purchased by him but to other lots shall give to the purchasers of such other lots an acknowledgement of their right to production of such documents and to delivery of copies thereof and an undertaking for their safe custody. Every acknowledgment and undertaking under this condition shall be prepared by and at the expense of the person to whom it is given and shall be perused by or on behalf of the person giving the same at his own expense.

14.—The sale is made subject to the approval of the Chancery Division of the High Court of Justice and the Vendors shall forthwith take and carry to completion all necessary steps and proceedings and use their best endeavours to obtain by means of an application to the Court its approval of the agreement referred to in the second condition, and in case such approval shall not be obtained either in the terms thereof or with such variations as may be assented to by both parties on or before the 14th day of May next, then such agreement shall be void.

15.—If the purchaser of any lot shall fail to comply with these conditions his deposit money shall be forfeited to the Vendors, who shall be at liberty to re-sell that lot either by public auction or private contract with or without notice to the purchaser at the present sale, and the deficiency (if any) arising on the re-sale, together with all charges attending the same, shall immediately after such sale be made good by the defaulter at this present sale as liquidated damages.

*Memorandum. At the Sale by Auction made this day of the property comprised
in the above particulars
of
was the highest bidder for and was declared the purchaser of Lot at the
price of and he has
paid to Messrs. Parker & Parker, the Vendors' Solicitors, the sum of
by way of deposit
and in part payment of the purchase money and the said
hereby agrees to complete the purchase according to
the above conditions.*

Dated this

day of

1903.

Purchase Money £

Deposit paid

SALE PLAN

OF

NOYNA ESTATE, FOULRIDGE.

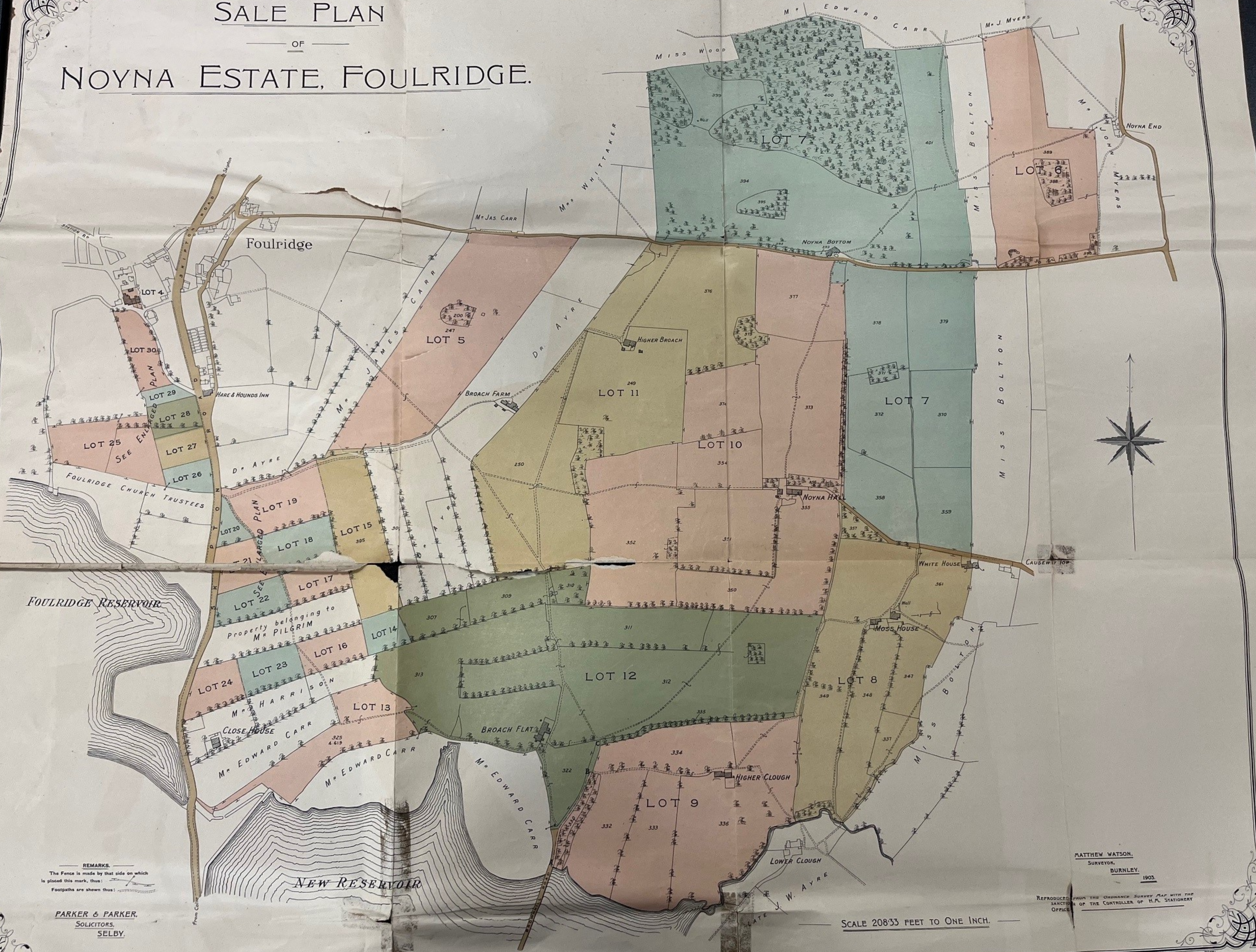

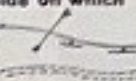
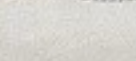
REMARKS.
 The Fence is made by that side on which is placed this mark, thus: 
 Footpaths are shown thus: 

PARKER & PARKER,
 SOLICITORS,
 SELBY.

MATTHEW WATSON,
 SURVEYOR,
 BURNLEY,
 1903.

REPRODUCED FROM THE ORDNANCE SURVEY MAP WITH THE SANCTION OF THE CONTROLLER OF H.M. STATIONERY OFFICE.

SCALE 20833 FEET TO ONE INCH.