

This drawing shows the County Council's currently approved proposals. These may be subject to change because of further developments in the design or the statutory processes.

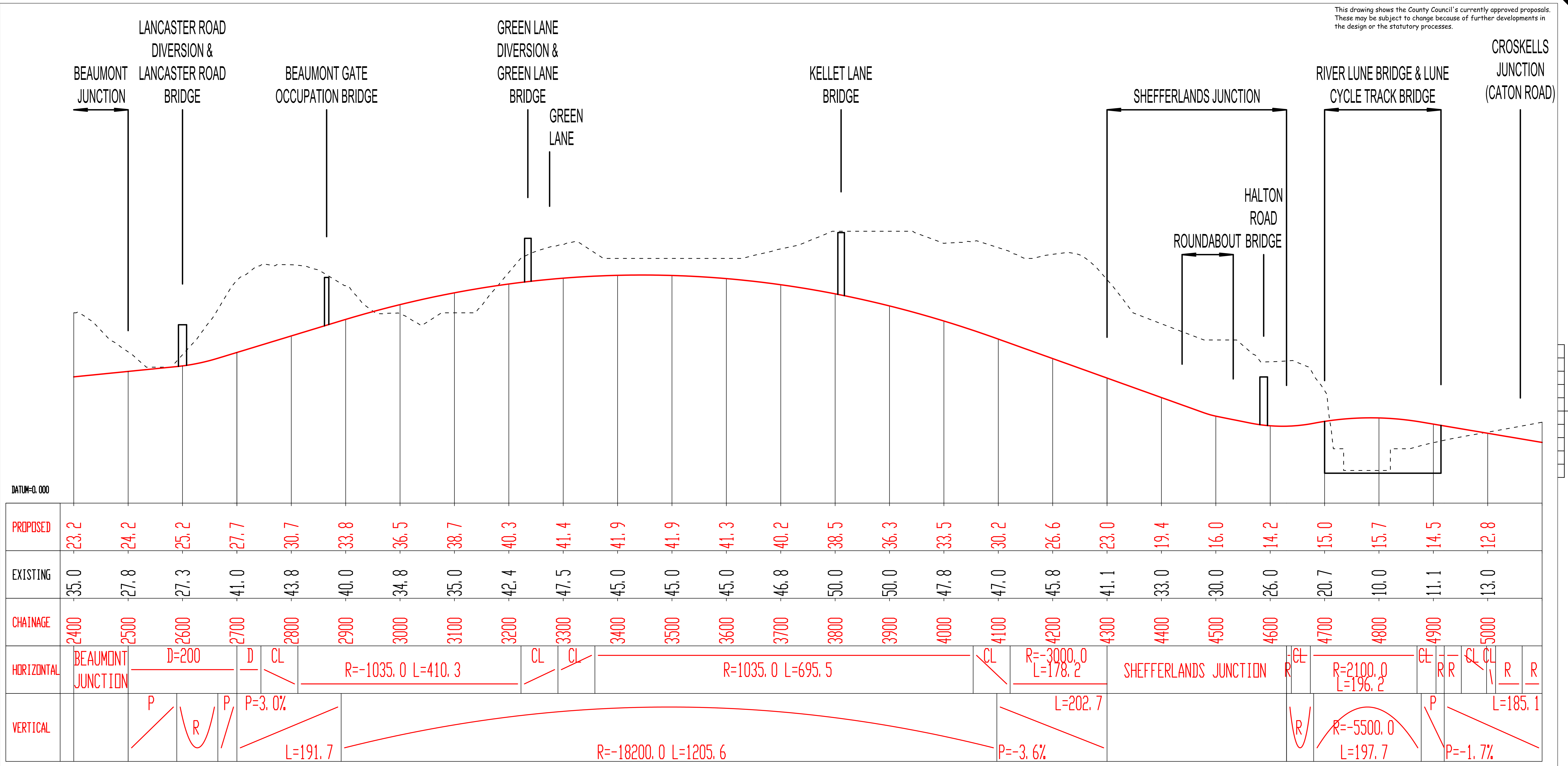

Scale 1:2500H / 1:250V

Figure 3B - A6 Lancaster Road to A683 Caton Road (Profile)

Based on Ordnance Survey Mapping with the Permission of the Controller of Her Majesty's Stationery Office. Crown copyright. Unauthorised reproduction prohibited. Copyright may also be held by other persons. Lancashire County Council Licence No. LA20/18